



2 BHK LUXURIOUS FLATS & SHOPS

ENJOY

COMFORT AND CONVENIENCE AT OUR FABULOUS APARTMENTS.
Experience the perfect combination of comfort, convenience and luxury at our apartments.



GROUND FLOOR LAYOUT

SHOP AREA TABLE

NO.	SIZE	C.A.	NO.	SIZE	C.A.	NO.	SIZE	C.A.
01	15'4"x20'4"	312	08	10'0"x25'4"	253	15	10'0"x25'4"	253
02	10'0"x25'4"	253	09	10'0"x25'4"	253	16	7'0"x25'4"	178
03	10'0"x25'4"	253	10	7'0"x25'4"	178	17	7'0"x25'4"	178
04	7'0"x25'4"	178	11	7'0"x25'4"	178	18	10'0"x25'4"	253
05	7'0"x25'4"	178	12	10'0"x25'4"	253	19	10'0"x25'4"	253
06	10'0"x25'4"	253	13	10'0"x25'4"	253			
07	10'0"x25'4"	253	14	10'0"x25'4"	253			

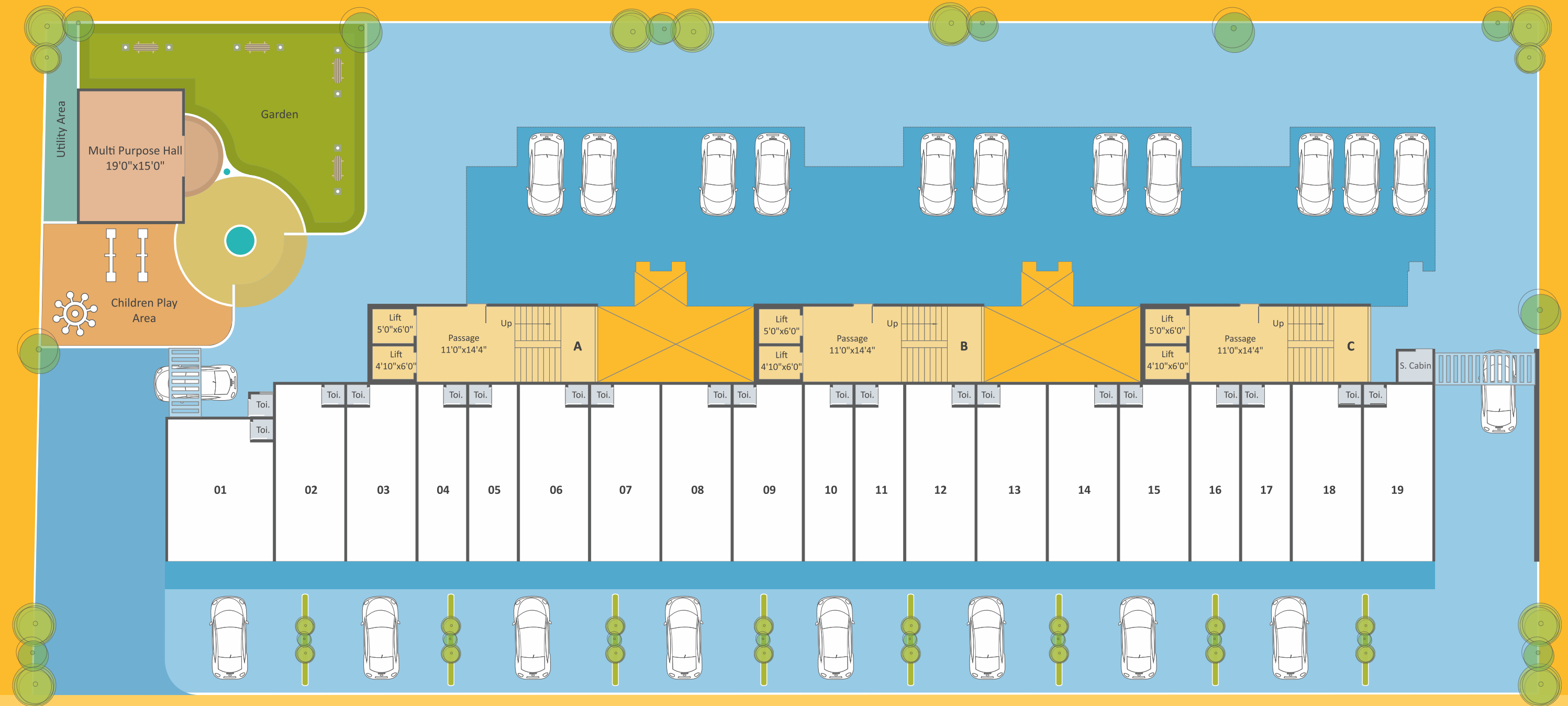

12.00 M t . W i d e R o a d

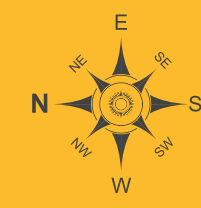

TYPICAL
FLOOR LAYOUT

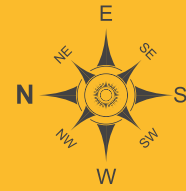
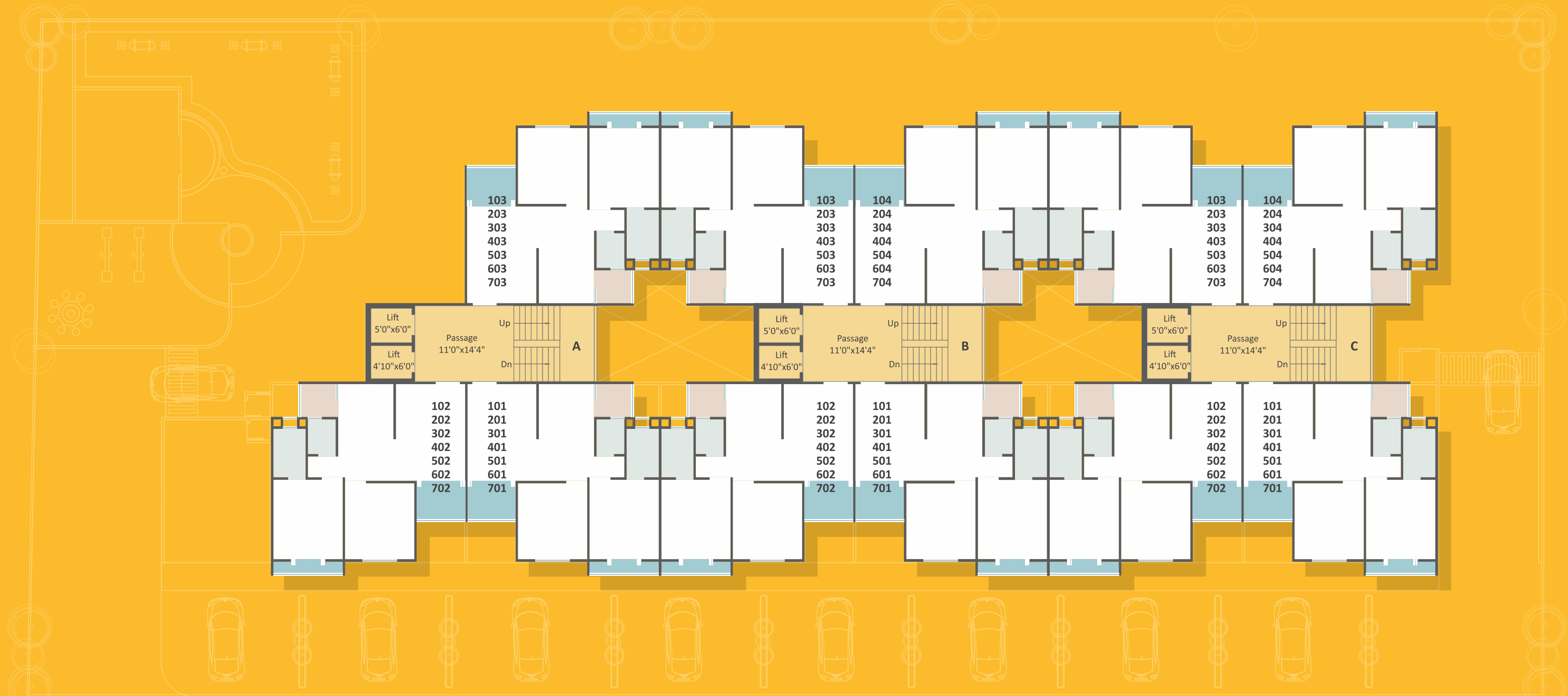

1 2 . 0 0 M t . W i d e R o a d



**TOWER
A-B-C**
TYPICAL FLOOR PLAN

Carpet Area : 573 sq.ft.
Balcony + Wash Area : 61 sq.ft.
Builtup Area : 667 sq.ft.

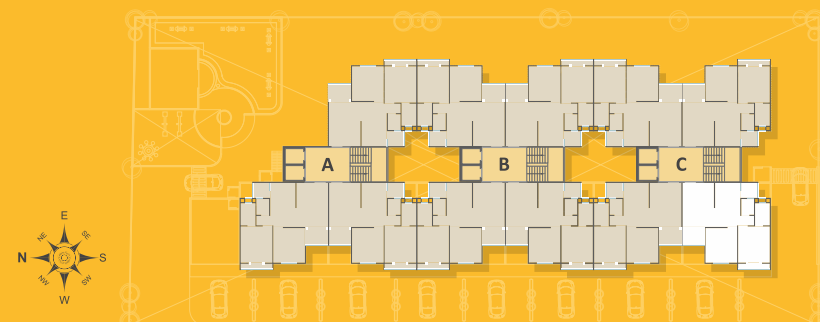

SPECIFICATIONS

STRUCTURE : Well designed RCC frame structure With good quality material as per structural Engineer's design specifications.

FLOORING : Vitrified tiles flooring with skirting in entire Apartment.

DOORS : Elegant entrance door and flushed internal Door with wooden figure laminated and safety latch Main door.

WINDOWS : Aluminum windows with powder coated paint with safety grills.

WALLS : Interior walls painted with distemper emulsion, exterior paint with water proof and fungal resistant paint.

WATER SUPPLY : Underground and overhead tank 24 hours water supply with auto control system. RO System to each flat.

KITCHEN : Premium quality granite platform with ss sink & lintel Height dado with designer tiles above platform.





LIFE FEELS SO COMPLETE WHEN WE'RE TOGETHER.

 <p>Internal road with RCC & Street Light</p>	 <p>Children's Play Area</p>	 <p>Checked Tiles Flooring all Parking Area</p>	 <p>Clubhouse</p>
 <p>Standard Quality Passenger Elevator</p>	 <p>Power Backup For Lift & Common Lights</p>	 <p>Number Plate & Letter Box</p>	 <p>Senior Citizen Sittings</p>
 <p>Party Lawn</p>			



Developers
NEELA CREATION

RIA ENCLAVE - Bs. Radhe Residency,
Behind Makarpura Airforce Station,
Makarpura, Vadodara.

M : **+91 93160 88638**

E : neelacreationvadodara@gmail.com

W : www.riaenclave.in

Architect :
space plus

Structure : Zarna Associates



PAYMENT MODE • 10% Booking • 15% Plinth Level • 5% Ground Floor Slab • 5% First Floor Slab • 5% Second Floor Slab • 5% Third Floor Slab • 5% Fourth Floor Slab • 5% Fifth Floor Slab • 5% Sixth Floor Slab • 5% Seventh Floor Slab • 10% Masonary Work • 10% Plaster Level • 10% Flooring • 5% on Possession

(1) Possession will be given after 30 days of settlement of all accounts. (2) Stamp Duty, Registration, Legal Charges, GST, MGVCCL & VMSS Charges, Society Maintenance Deposits & Development Charges, etc will be borne by the Purchaser. (3) Any additional charges or duties levied by the Government / Local authorities during or after the completion of the scheme will be borne by the Purchaser. (4) Extra work shall be executed after making full payment. (5) Continuous default payments lead to cancellation. (6) Architect / Developers shall have the right to change or raise the scheme or any details herein and any change or revision will be binding to all. (7) In case of delay in water supply, electric light connection, drainage work by the concerned authority, developers will not be responsible. (8) Refund in case of cancellation will be made within 30 days from the date of booking of new client only. (9) Administrative expense of Rs.20000/- & the amount of extra work (if any) will be deducted from refund amount. (10) Any plans, specifications or information in this brochure can not form part of an offer, contract or agreement.

RERA No. : PR/GJ/VADODARA/VADODARA/Others/MAA07622/031120 - www.gujrera.gujarat.gov.in